

Jason International, Inc.
8328 MacArthur Drive
North Little Rock, AR 72118
www.jasoninternational.com
MADE IN THE U.S.A.



JASON
HYDROTHERAPY

49-2005-000
Date 11/14

OWNER'S MANUAL

MicroSilk® Shower Wand and Hose Assembly (Generation 1) OPERATION AND MAINTENANCE

INTRODUCTION

Jason's MicroSilk Wand is designed as an accessory to your MicroSilk Bath and provides all the benefits of MicroSilk to the bather's face, scalp and upper body. Simply plug Wand into one of the bath's MicroSilk jets before turning on the system. After jet is securely plugged, direct Wand as desired and turn on the system to begin flow.

Included with each MicroSilk Shower Wand and Hose Assembly:

- One (1) MicroSilk Shower Wand
- One (1) 63" Shower Hose
- One (1) Shower Wand Adapter
- Two (2) Hose Gasket Washers

INSPECTION

Inspect the kit for damage and any shortages prior to installation. Damage sustained in transit is the responsibility of the carrier. If transit damage is discovered, notify the carrier immediately and file a freight claim with them. If any shortages are noted, contact Jason Customer Service at 800-255-5766.

OPERATION

- 1) Locate the MicroSilk Shower Wand Jet Adapter. See Figure 1.
- 2) Before turning on the system, choose the MicroSilk jet into which you wish to plug the MicroSilk Wand. Connect the Shower Wand Jet Adapter into the jet. See Figure 2.
- 3) After jet is securely plugged in, direct the MicroSilk Shower Wand as desired and turn on the system to begin flow.
- 4) After use, turn off the system and disconnect the Shower Wand Adapter from the MicroSilk jet.

NOTE: The MicroSilk Shower Wand should be disconnected after each use to ensure that the MicroSilk system drains properly. The Shower Wand should be drained and stored in a safe location. For easier removal of the adapter fitting, hold the escutcheon in place while removing the adapter.

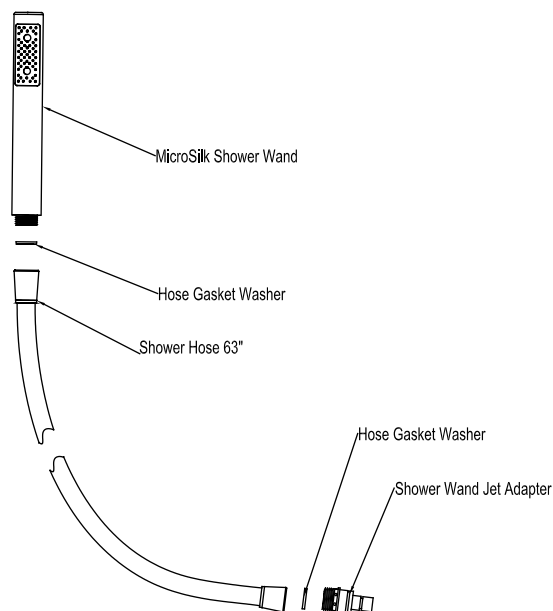

Figure 1

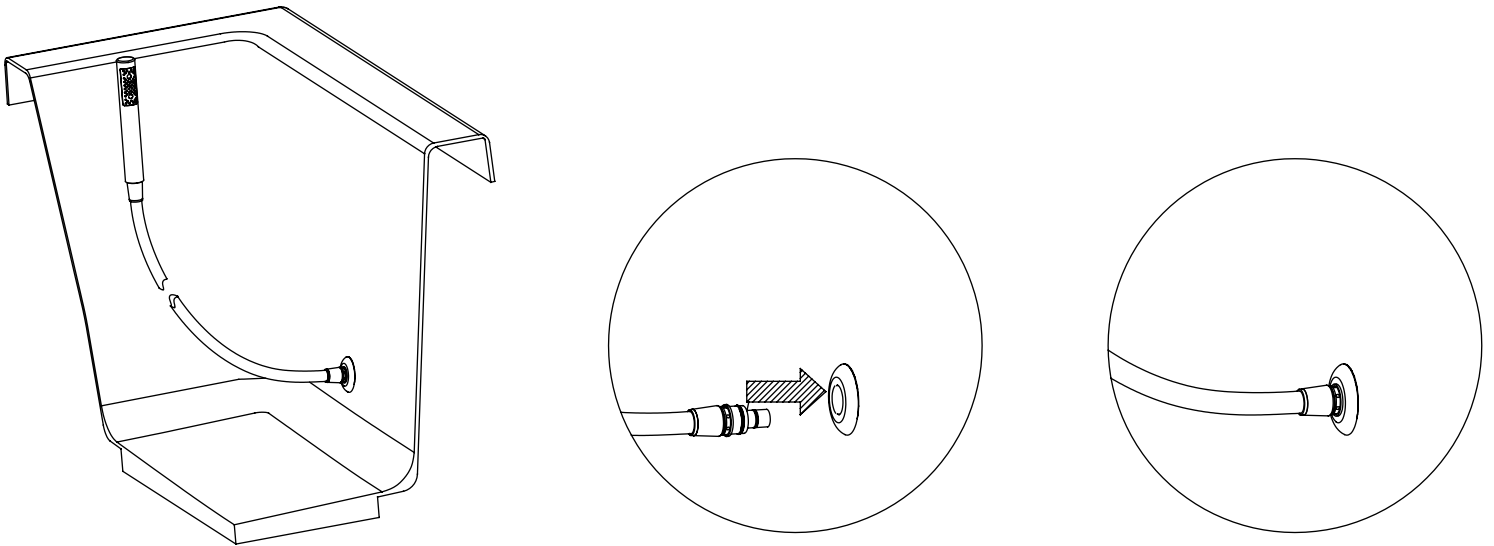

Figure 2

CLEANING

In order to maintain the high quality finish of the product you have purchased, please adhere to the following product care instructions.

For routine cleaning, simply use a soft damp cloth and common household soap, then rinse and dry. Proper care of your product is important because most water contains calcium that deposits on surfaces, forming undesired spots. This can be avoided by routine cleaning and drying after every use. Use only mild soap-based detergents. Never use abrasive cleaners, bleach, disinfectants or cleaning

products containing alcohol, ammonia, hydrochloric or phosphoric acids as they will damage the product finish.

Over time, calcium may build up in the nibs and diminish the performance of your shower product. Rubbing your fingers over the nibs occasionally while operating your shower product will clear the calcium build up.

Please note: Your product warranty may not be valid if the above cleaning guidelines are not followed.