

UNDERMOUNTABLE: Yes

FAUCETRY DECK: No

TEXTURED FLOOR: No

<div style="text-align: center;"> S SOAKING <small>Includes Level-Form™ Base</small> </div> <div style="text-align: center; font-size: 1.5em; font-weight: bold;">\$3,305</div> <div style="text-align: center; font-size: 1.2em; font-weight: bold;">(1165.00.00.CC)</div>		<small>All hydrotherapy equipment is rated for 120V, 20A (US) Consult Spec Sheet on website for Boxed Weight & Cube. .CC = Color Code / See page 155 for color options.</small> Operating Cap: 48 U.S. Gal.		STANDARD	PREMIER
		Includes: • Linear Overflow Drain • Touch Control Pad • 20-minute timer	All Standard features plus: • Ozone • Digital Control Pad • LED Chromatherapy		
W WHIRLPOOL	Includes 5 adjustable jets with pump unit indicated.	\$6,445	\$7,665		
a AIRMASSEUR [®]	Includes 40 strategically located air jets, 1hp blower w/ heater.	\$6,545	\$7,765		
m MICROSILK [®]	Includes 1 MicroSilk delivery port, MicroSilk unit.	\$6,305	\$7,525		
aw AIRMASSEUR [®] WHIRLPOOL	Includes 5 adjustable jets and 40 air jets; 1.5 hp pump; 1hp blower w/ heater. Combines all features provided with both W & a equipped Standard or Premier baths, respectively.	\$8,385	\$9,605		
mw MICROSILK [®] WHIRLPOOL	Includes 5 adjustable jets and 1 MicroSilk delivery port; MicroSilk unit; 1.5 hp pump. Combines all features provided with both W & m equipped Standard or Premier baths, respectively.	\$9,440	\$10,660		
ma MICROSILK [®] AIRMASSEUR [®]	Includes 1 MicroSilk delivery port, 40 strategically located air jets; MicroSilk unit; 1hp blower w/ heater. Combines all features provided with both a & m equipped Standard or Premier baths, respectively.	\$9,545	\$10,765		

Designer
DROP-IN

Control pad can be mounted on opposing side of vessel by request.

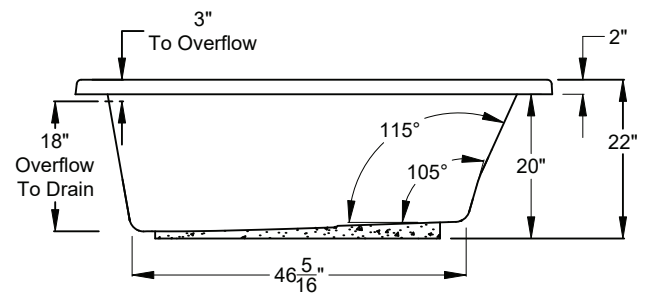
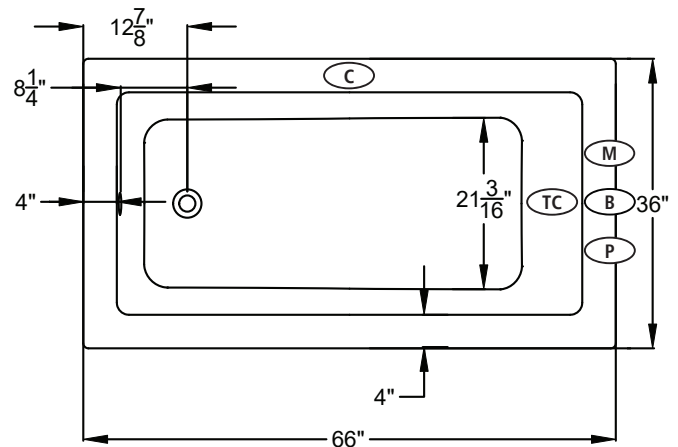

*Blower must be remote mounted on MicroSilk[®]-AirMasseur[®] and Air-Whirlpool baths. See page 130 for remote blower mounting.

- P Whirlpool Pump Location
- M MicroSilk[®] Unit Location
- C Control Location
- B Blower Location
- TC Thermo Comfort Heating Pad Location

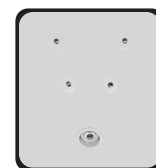

1 set of Back-Stack™ jets on W mw (Optional)

NOTE: mw equipment may extend beyond the perimeter of the bath. Consult factory for details.

Bath Options

For handle information, see page 127.
For details & additional options, see page 128-130.

GH400 HANDLE - Factory installed. <small>Accepts 2 handles. Price is per handle. If ordering 1 handle, indicate handle installation.</small>	8709-04-0CC	\$315	
JETTED NECK PILLOW - Page 128 W mw	8707-50-0CC	\$1,145	
BACKSTACK™ JETS - Page 128 W mw	8707-30-001	\$930	
BLUETOOTH SOUND IMMERSION SYSTEM - Page 128	8724-01-000	\$835	
WATER LEVEL SENSOR - Page 128	8724-02-000	\$1,030	
THERMO COMFORT - Page 129 S W m mw	8706-04-XXX	\$840	
MICROSILK SHOWER WAND - Page 129	Polished Chrome	8705-55-091	\$505
LINEAR OVERFLOW DRAIN KITS - For finish options, see Page 129.	Polished Chrome	MLD-PC	Included
	Optional Finishes	MLD-XX	ADD \$120
TILE FLANGE KIT - Page 129	8707-11-001	\$190	