

Bath Prefix - 1186.07

	STANDARD	PREMIER	SIGNATURE
	<ul style="list-style-type: none"> • 120V • Touch Control • 20-minute timer 	<ul style="list-style-type: none"> • 120V • Digital Control • 20-minute timer • Ozone • LED Light 	<ul style="list-style-type: none"> • 120V • Digital Control • 20-minute timer • Ozone • LED Light • Bluetooth Sound Immersion • Water Level Sensor
(M) MICROSILK [®]	\$9,900 (1186.07.61.CC)	\$10,635 (1186.07.65.CC)	\$12,170 (1186.07.63.CC)
(A) AIRMASSEUR [®]	\$8,610 (1186.07.21.CC)	\$9,695 (1186.07.25.CC)	\$11,035 (1186.07.23.CC)
(S) SOAKING	\$4,945 (1186.07.00.CC)		



forma[®] Collection

Please specify when ordering

- **Standard Color:** CC= White-WT (01), Bisquite-BQ (40).
- CUSTOM COLOR** for color chart & codes, see pg. 133

Bath Options

For handle information, see page 127.
For additional options and details, see page 128-130.

GH400 HANDLE Factory installed. Accepts 1 handle across from overflow.				\$315
ACRYLIC EQUIPMENT CABINET - Page 129 (A)				\$1,225
BLUETOOTH SOUND IMMERSION SYSTEM - Page 128				\$835
THERMO COMFORT - Page 129				\$840
MICROSILK SHOWER WAND - Page 129 (M)	Polished Chrome	8705-51-091		\$505
LINEAR OVERFLOW DRAIN KITS For finish options, see page 129.	Polished Chrome	LDK-PC	Included	
	Optional Finishes	LDK-XX	ADD \$120	
TILE FLANGE KIT - Page 129				N/A

Feature Information

- (M)** Includes 1 MicroSilk delivery port, MicroSilk unit.
- (A)** Includes 40 strategically located air jets, 1hp blower w/ heater. Blower must be remote mounted if Acrylic Equipment Cabinet not selected.

Consult Spec Sheet on website for Boxed Weight & Cube. Operating Cap: 39 U.S. Gal. 120V, 20A (US)

- (C)** Control Location
- (E)** Equipment Cabinet
- (TC)** Thermo Comfort Heating Pad Location

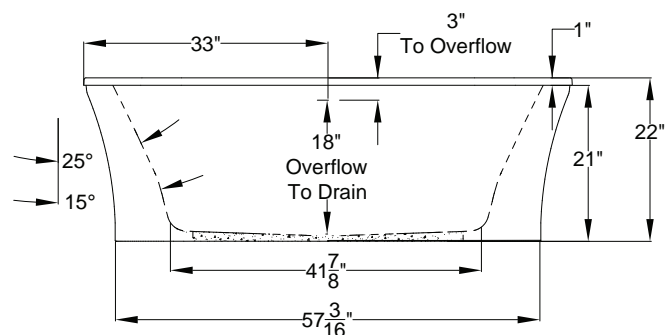
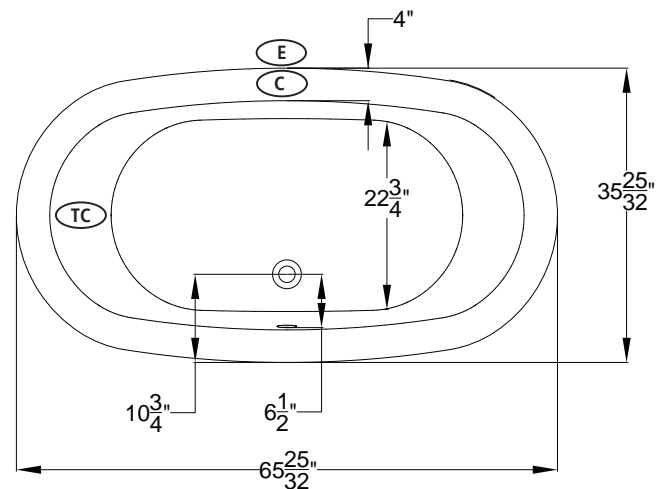

Acrylic Equipment Cabinet is required on MicroSilk[®] baths and is available as an option on Airmasser[®] baths.

